

NEW!

MLC Series

(Cylindrically-Shaped Metallized Polypropylene Film Capacitors)

- Cylindrically-shaped capacitor with big capacitance for wind & solar power inverters, other inverters, chopper control and charge-discharge.
- High reliability of withstanding voltage due to using of our original segmented metallized film.



Product Specifications

| Items | Specifications | | | | |
|-----------------------|--|------------|-------|-------|-------|
| Temperature range | -40~+85°C (with derating over 70°C) WV: rated voltage | | | | |
| | Ambient temperature | Under 70°C | 75°C | 80°C | 85°C |
| | Maximum operating voltage | 1.0WV | 0.9WV | 0.8WV | 0.7WV |
| Rated voltage | 1100, 1300V.DC | | | | |
| Capacitance tolerance | ±5%(J), ±10%(K) at 20°C, 1kHz | | | | |
| Test voltage | Between terminal : Rated voltage × 1.5 10sec | | | | |
| | Between T-C : 3000V.AC 10sec | | | | |
| Related standards | IEC61071 | | | | |

Product code : (Example) 1100V.DC 580μF ±5% φ116×~125 with stud bolt

MLC-1100V-587-J-B-116125

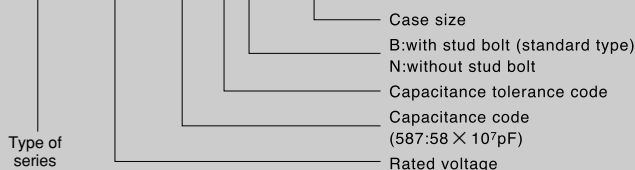

Standard value and case size

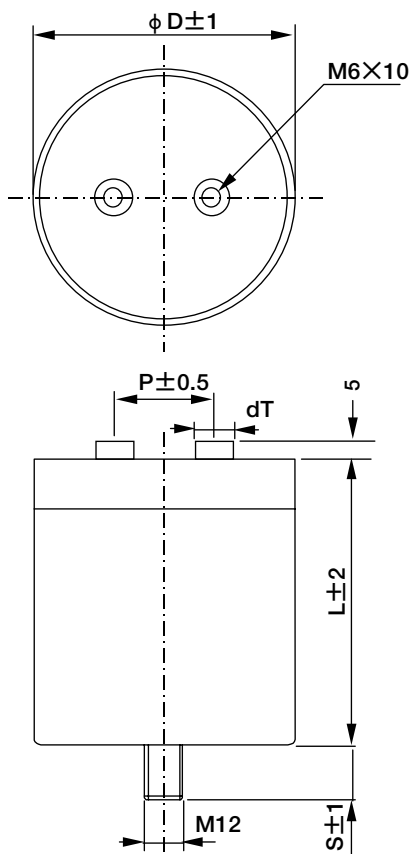

Upper part : official capacitance Lower part : maximum ripple current at 60°C, 1~10kHz

| Case size (mm) | φ D | φ 85 | | φ 100 | | φ 116 | |
|----------------------|------|--------|--------|--------|--------|--------|--------|
| | L | 125 | 175 | 125 | 175 | 125 | 175 |
| Rated voltage [V.DC] | 1100 | 290 μF | 460 μF | 440 μF | 690 μF | 580 μF | 920 μF |
| | | 36Arms | 35Arms | 46Arms | 44Arms | 53Arms | 52Arms |
| | 1300 | 210 μF | 330 μF | 300 μF | 470 μF | 420 μF | 660 μF |
| | | 34Arms | 33Arms | 42Arms | 41Arms | 50Arms | 49Arms |

| | | mm | | | |
|-----------|-------------------|-----|------|-------|-------|
| | | φ D | φ 85 | φ 100 | φ 116 |
| Terminal | P | | 32 | 50 | |
| | dT | | φ 12 | φ 14 | |
| | Tightening torque | | 4Nm | | |
| Stud bolt | S | | 16 | 18 | |
| | Tightening torque | | 7Nm | | |

Ripple current correction coefficient

| Operating voltage [V.DC] | 0.7WV | 0.8WV | 0.9WV | 1.0WV | |
|--------------------------|-------|-------|-------|-------|-----|
| Ambient temperature | 50°C | 1.6 | 1.5 | 1.4 | 1.2 |
| | 60°C | 1.5 | 1.4 | 1.2 | 1.0 |
| | 70°C | 1.1 | 0.9 | 0.6 | 0.0 |
| | 75°C | 0.9 | 0.6 | 0.0 | |
| | 80°C | 0.6 | 0.0 | | |
| 85°C | 0.0 | | | | |

- Please inquire us in case low frequency (commercial frequency) or frequency above 10kHz is included in ripple current.
- Please multiply correction coefficient by ripple current except the rated voltage at 60°C is applied to capacitor. However, as per the permissible terminal voltage, 60Arms for φ 85 and φ 100 and 80Arms for φ 116 should be as upper limit of current.